

DO NOT CUT FLANGE

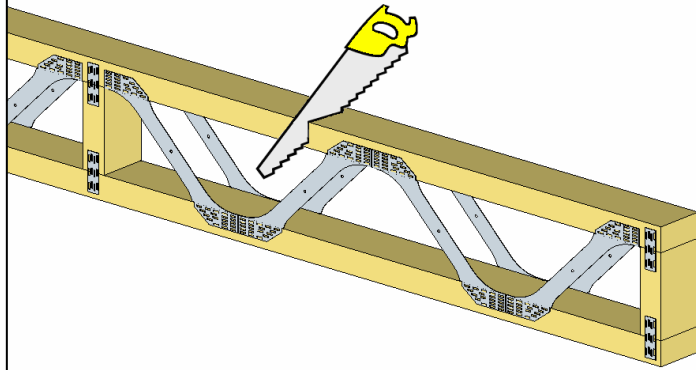

DO NOT DRILL FLANGE

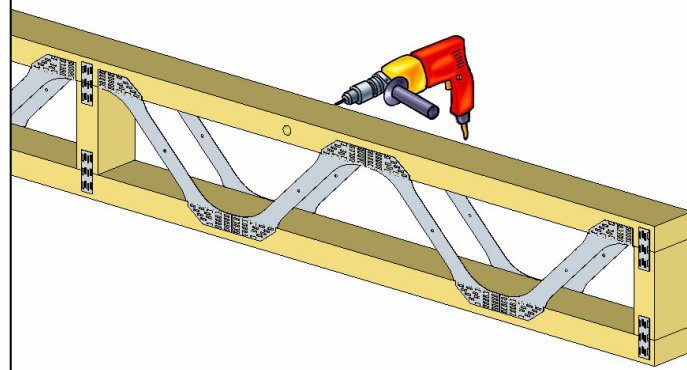

DO NOT REMOVE COLUMNS

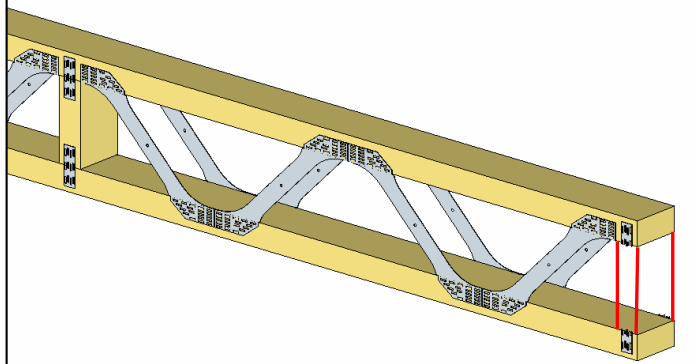

DO NOT DAMAGE WEBS

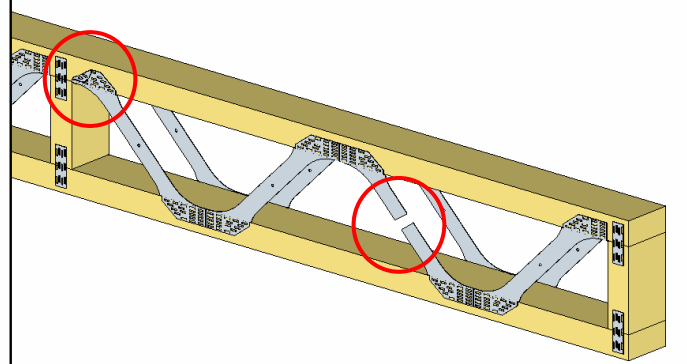

DO ORIENT CORRECTLY

Joists are designed with a specific top and bottom chord. Refer to joist profile plots for correct orientation.

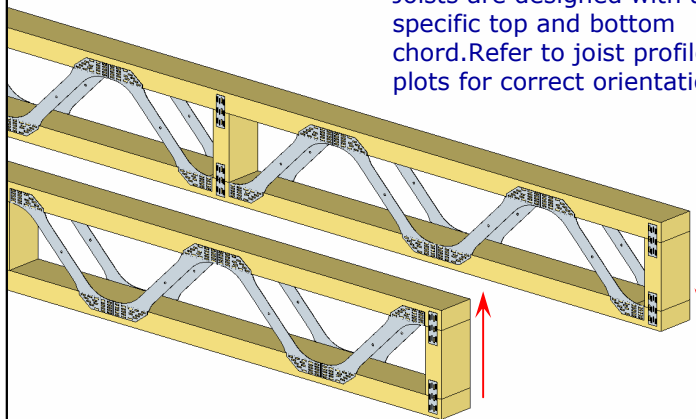

DO SPACE CORRECTLY

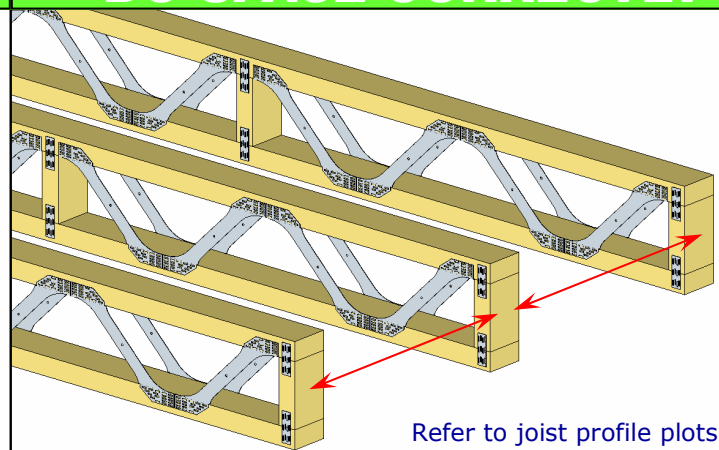

Refer to joist profile plots for maximum joist spacing.

easi-joist®

Metal Web Floor System

Site Installation and Handling Guide - Masonry Wall Buildings

To be used in conjunction with drawings and information supplied by the joist manufacturer.

Services

Clearance for circular services

	WS200	WS250	WS300	WS400
A (mm)	125	160	210	323
D (mm)	100	150	200	280

Clearance for rectangular services

H (mm)	W (mm)	W (mm)	W (mm)	W (mm)
50	300	300	330	500
100	100	200	250	410
150	50	70	170	330
200			70	250
250				170
300				70

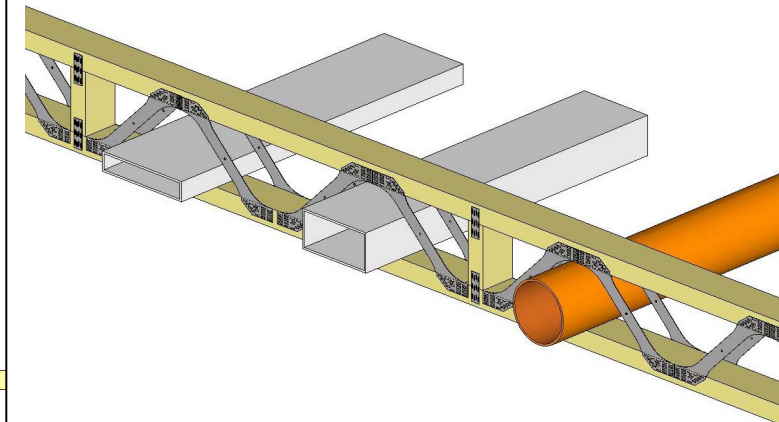
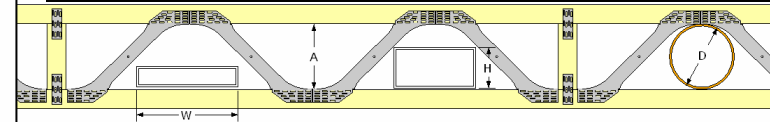

Safety Information:

All joists to be erected truly vertical, parallel and the correct way up. Refer to joist profiles on floor layout plan for correct joist orientation.

easi joists may not be notched, drilled or cut without the express permission of the manufacturer.

Joists are unstable until fully braced. Do not walk or place heavy loads on an unrestrained floor area.

Noggins, restraint straps, decking and strongbacks (where applicable) should be properly installed as specified by the designer before the floor system is used.

Where masonry hangers are used, ensure at least three courses of blockwork or equivalent have been laid and the mortar cured before the floor is used.

Observe health and safety regulations for manual lifting of heavy loads and working at height.

Handling and Storage:

Do not allow easi-joists to be exposed to prolonged heat or moisture.

Always store easi-joists upright on a flat surface or a set of bearers.

Avoid dropping easi-joists or subjecting them to heavy impacts.

Always lift easi-joists in an upright orientation.

Use protective gloves when manually handling easi-joists.

Loading:

easi-joists are designed in accordance with:

BS5268 — Structural Use of Timber
BS6399 — Loading of Buildings

Loading and joist spacing must not exceed that stated on the design layout drawings.

Wolf Systems Ltd © Copyright 2009
Version EJMSG 0309.1



The Constructive Partner

Wolf Systems Limited
Shilton Industrial Estate
Shilton, Coventry, CV7 9QL
T 0044 (0)2476 602 303
F 0044 (0)2476 602 243
E mail@wolfsystem.co.uk
www.wolfsystem.co.uk

Supplied by:

EJ1: Face Fix Hanger

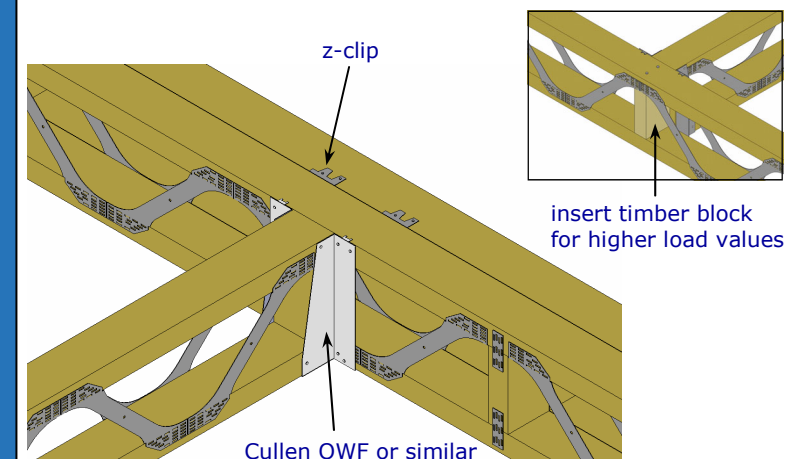

EJ2: Strap Hanger

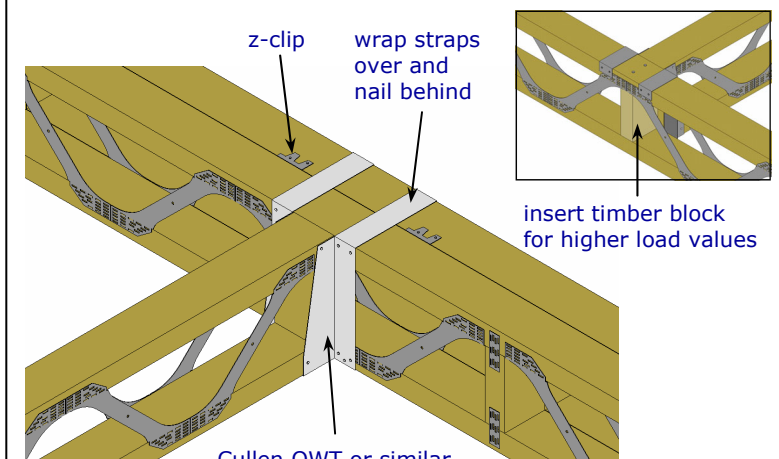

<p>EJ3: Top Chord Support onto Steel</p> <p>packers</p> <p>wallplate</p> <p>continuous plasterboard noggin</p> <p>timber packer fixed to steel</p>	<p>EJ4b: Intermediate Support (onto block wall)</p> <p>locate columns directly over support</p>	<p>EJM2: Hanger with Continuous Restraint</p> <p>continuous top chord restraint</p> <p>joist with web post on bottom chord</p>	<p>EJM3: Bottom Chord Support Built In</p> <p>continue masonry between joists</p>
<p>EJ5: Stair Opening with easi-joist</p> <p>z-clip</p> <p>easi-joist trimmer</p> <p>Cullen OWF or similar (see EJ1)</p>	<p>EJ6: Stair Opening with Binder</p> <p>OWF/OWT hanger to suit</p> <p>top chord supported easi-joist</p> <p>solid or composite timber binder</p>	<p>EJM4: Top Chord Support Built In</p> <p>noggin</p> <p>continuous ledger</p>	<p>EJM5: Top Chord Support with Ledger</p> <p>packers</p> <p>top chord fixed to wallplate</p> <p>continuous ledger</p>
<p>EJ7: Strongback</p> <p>nail strongback to side of easi-joist column</p>	<p>EJ8: Strongback Lapping</p> <p>strongbacks must both be fixed to 2 of the same easi joists</p>	<p>EJM6: Lateral Restraint of Strongback</p> <p>strap fixed with min 4 nails up to 3rd joist</p> <p>strongback</p>	<p>EJM7: Lateral Restraint Bracing</p> <p>strap fixed with min 4 nails up to 3rd joist</p> <p>35x97mm brace nailed twice to each</p>
<p>EJ9: Strongback Splice</p> <p>strongbacks butt together between joists</p> <p>splice timber spans two joists</p>	<p>EJM1: Hangers with Noggins</p>	<p>EJM8: S.V.P Detail with Trimmer</p> <p>face fix hanger</p> <p>S.V.P.</p> <p>trimmer</p> <p>Cullen JH hanger or similar</p> <p>top chord support with block to suit</p>	<p>EJM9: S.V.P Detail with Bearers</p> <p>S.V.P.</p> <p>Bearers fixed to masonry to support floor and ceiling</p> <p>Cullen JH hanger or similar</p>